

Mako G

G-192



- Latest e2v Sapphire CMOS sensor
- Switchable shutter modes
- PoE
- 60 fps @ 1.9 Megapixel

Description

GigE camera with e2v CMOS color sensor, 1.9 Megapixels

The Mako G-192B/C is an industrial GigE camera with the e2v EV76C570 sensor. Mako G cameras have the same 29 x 29 mm form factor and the same mounting positions as many analog cameras. All models include PoE, two opto-isolated outputs, and a 64 MB FIFO image buffer. The image quality profits from the precisely aligned sensors.

Options

- Various IR cut/pass filters, protection glass, various lens mounts
- White medical housing

Specifications

| Mako G | G-192 |
|-----------------------------------|---|
| Interface | IEEE 802.3 1000BASE-T, IEEE 802.3af (PoE) |
| Resolution | 1600 × 1200 |
| Sensor | e2v EV76C570 |
| Sensor type | CMOS Progressive |
| Sensor size | Type 1/1.8 |
| Cell size | 4.5 μm |
| Lens mount | C/CS-Mount |
| Max frame rate at full resolution | 60 fps |
| ADC | 10 bit |
| On-board FIFO | 64 Mbyte |
| Output | |
| Bit depth | 8/10 bit |

| Mako G | G-192 |
|---|--|
| Mono modes | Mono8, Mono10 |
| Color modes YUV | YUV411Packed, YUV422Packed, YUV444Packed |
| Color modes RGB | RGB8Packed, BGR8Packed |
| Raw modes | BayerGB8, BayerGB10 |
| General purpose inputs/outputs (GPIOs) | |
| Opto-isolated I/Os | 1 input, 3 outputs |
| Operating conditions/dimensions | |
| Operating temperature | +5°C to +45°C (housing temperature) |
| Power requirements (DC) | PoE / 12 V - 24 V |
| Power consumption (@12 V) | 2.4 W (PoE) / 2.1 W (non-PoE) |
| Mass | 80 g |
| Body dimensions (L × W × H in mm) | 60.5 × 29 × 29 mm, incl. connectors |
| Regulations | CE, FCC Class B, RoHS |

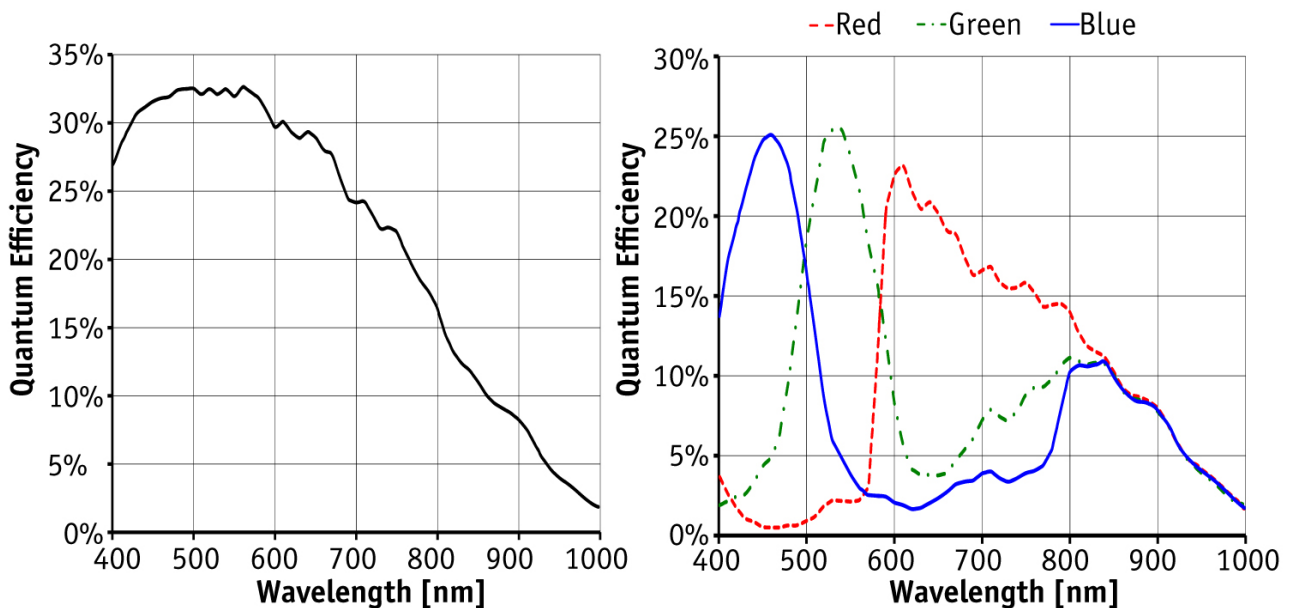

Features

- Switchable Rolling / Global / GlobalReset shutter modes
- Camera temperature monitoring
- Pixel defect masking
- ROI, separate ROI for auto features
- Binning
- Decimation
- Auto gain (manual gain control: 0 to 24 dB)



- Auto exposure
- Auto white balance
- LUTs (look-up tables)
- Gamma
- Hue, saturation, color correction
- ReverseX/Y
- StreamBytesPerSecond (easy bandwidth control)
- Stream hold
- Sync out modes: Trigger ready, input, exposing, readout, imaging, strobe, GPO
- Event channel
- Chunk data
- Storable user sets

Technical drawing

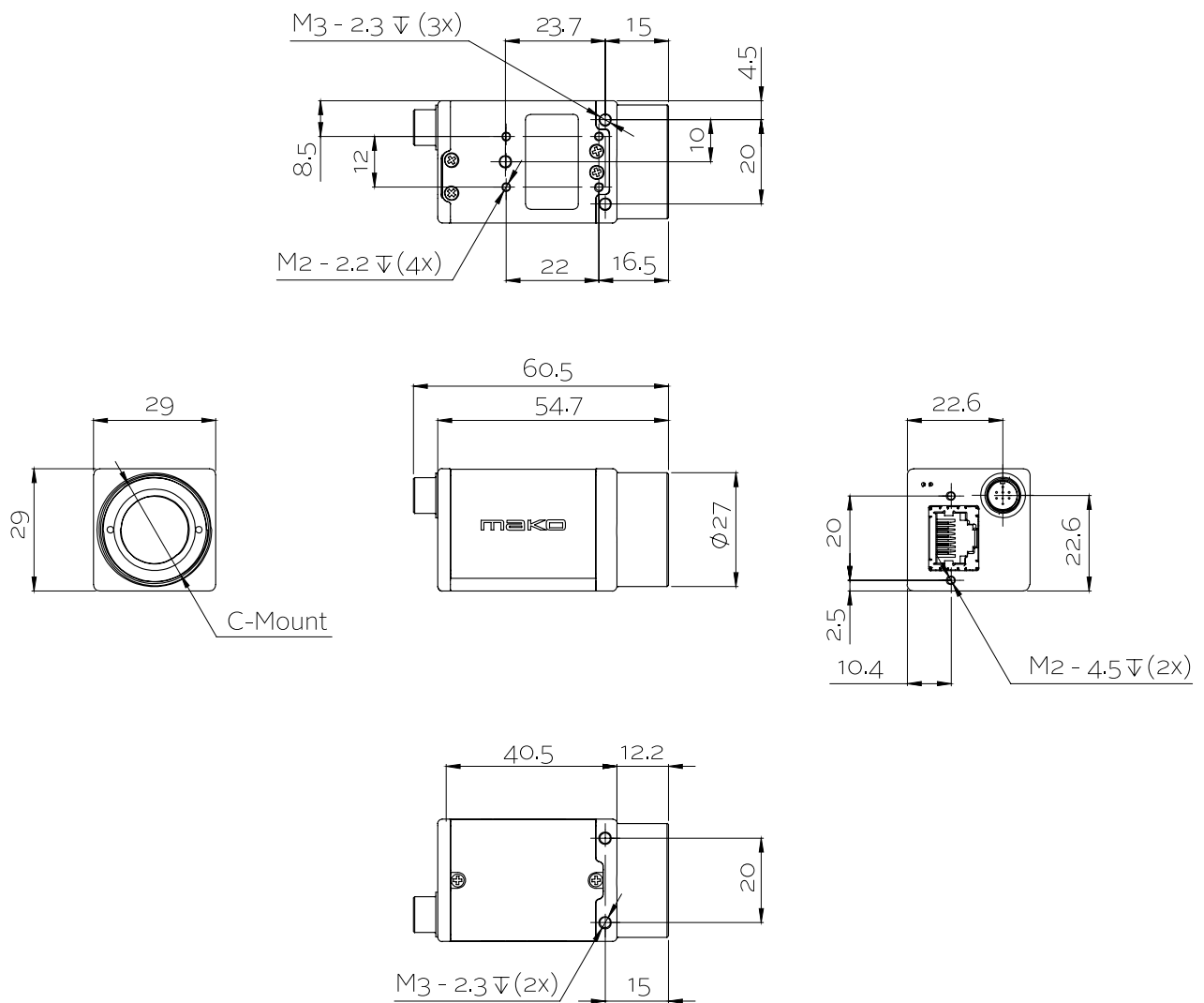



Applications

Mako G is an inexpensive industrial GigE camera with a compact form factor. It is suitable for all typical machine vision applications:

- Robotics
- Quality control
- Inspection, surveillance
- Industrial imaging
- Machine vision
- Logistics